

POWER1  
.....

Arenti®

# QUICK GUIDE

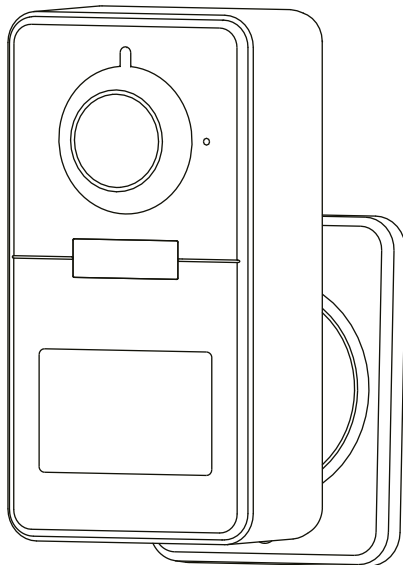

Compatible with Amazon Alexa & Google Assistant

# Quick start guide

1. Packing list
2. Product description
3. Installation
4. Product configuration
5. Legal notice

## 1. Packing list

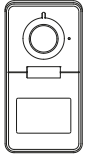

Camera X1

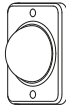

Bracket X1



Screws X3



USB cable X1



Quick guide X1

## 2. Product description

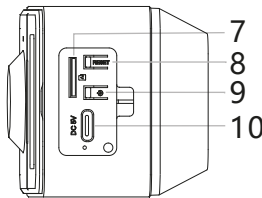
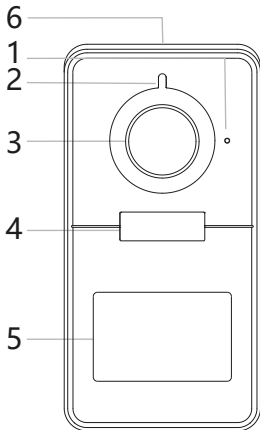

1. Microphone
2. LED indicator
3. Lens
4. Spotlight & IR Light
5. PIR
6. Speaker
7. SD card slot
8. Reset
9. Device ON/OFF
10. DC5V USB

### Notice

- To reset the device, press and hold the reset button for 5s.
- The camera beeps when the operation is completed.

Flashing red light (slow)	Wait for network config
Flashing red light (fast)	Connecting the network
Fixed red light	Network is malfunctional
Fixed blue light	Camera is working correctly

### 3. Installation

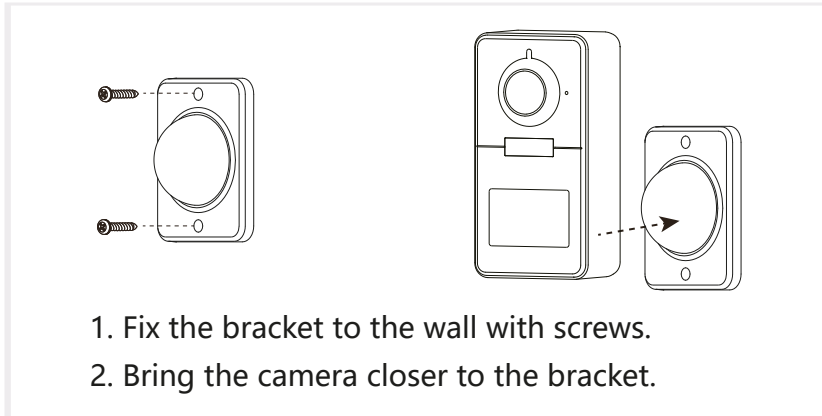

### 4. Product configuration

**Step 1** Turn on your camera.

**Step 2** Connect your smartphone to the Wi-Fi network.

**Step 3** Download Arenti app from the App Store or Google Play depending on your device.

**Step 4** Launch the App and sign up for the first use.

**Step 5** Follow the on-screen instructions to add your camera.

For more information, scan the QR code.

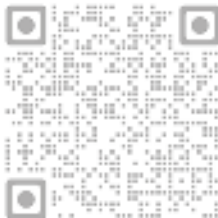

## Notice

- If you have multiple cameras, please follow step5 again to add devices one by one.
- To change Wi-Fi network, please restore the camera to factory settings and follow step 5 to add the camera.

## Specification

Min. brightness	Color 0.1Lux@F2.0
	Black and white 0.01Lux@F2.0
Lens	3.2 mm F2.0
FOV	130°
Shutter	1/15-1/10,000 per second
Infrared	High power LED with ICR
Infrared distance	10 meters
Spotlight color temperature	3000K
Spotlight distance	10 meters
Video compression	H.265
Bit rate	32Kbps - 2Mbps
Picture settings	Support HD/SD; support flip
Storage	SD card (Max 256GB)
Audio	Two-way audio
Protocols	TCP/IP, HTTP, DHCP, DNS
WiFi standard	IEEE802.11b/g/n
Frequency	2.4 GHz
WiFi encryption	WPA-PSK/WPA2-PSK
Security	AES128
Working temperature	-20°C~50°C
Power	DC5V,1A
Consumption	4.5W MAX
Size(mm)	79 x 56 x 115 (with bracket)
	50 x 56 x 115 (without bracket)

Battery	9600mAh
Standby consumption	600~800 $\mu$ A
Work consumption	150~200mA (IR off)
Standby time	12 months
Working time	4~6 months (10 times wake up per day)
PIR Detection	Up to 9 meters, 120°