

---

# Smart Blood Pressure Monitor



Nedis SmartLife

---

## Installation and Use

### BTHBP10WT

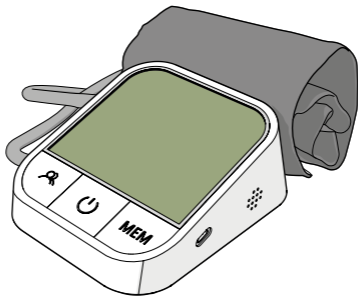

Scan the QR code for more information about your Nedis product or go to: [ned.is/bthbp10wt](https://ned.is/bthbp10wt)



Download



Nedis SmartLife



1

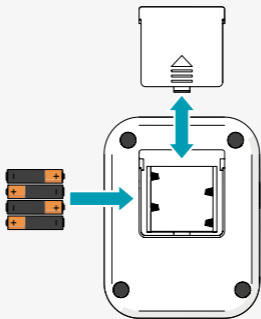

2

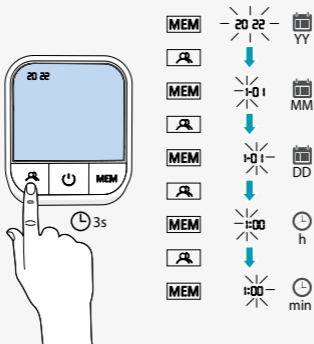

3



4



5

kPa ⇌ mmHg

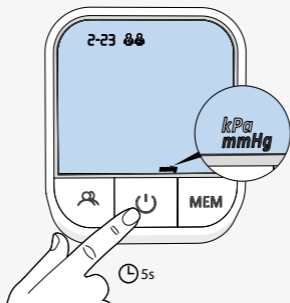

6

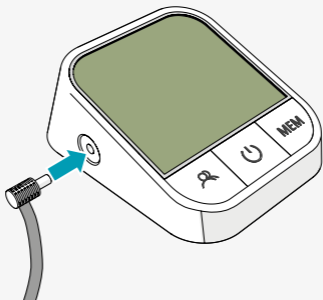

7

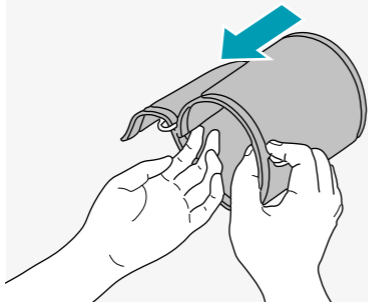

8

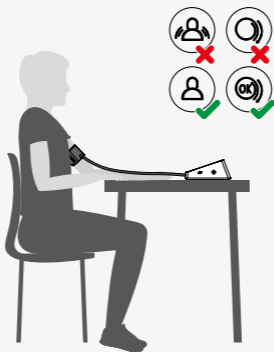

9

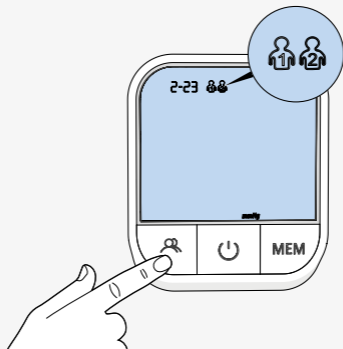

10

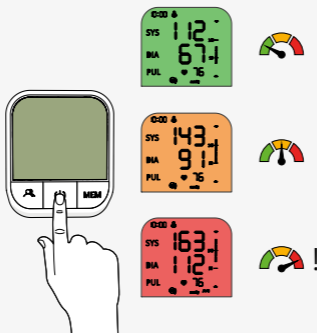

**Nedis B.V.**

De Tweeling 28  
5215 MC 's-Hertogenbosch  
The Netherlands  
[www.nedis.com](http://www.nedis.com)

