

START

1 Resistor - Weerstand - Résistance - Widerstand - Resistencia - Motstand - Vastus - Resistenze

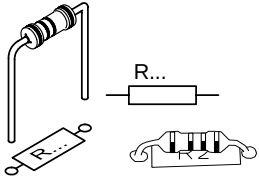

◇ R1: 1K	(Brown, Black, Red) - (Bruin, Zwart, Rood) - (Brun, Noir, Rouge) - (Braun, Schwarz, Rot) - (Brun, Svart, Röd) - (Ruskea, Musta, Punainen) - (Marrón, Negro, Rojo) - (Castanho, Preto, Encarnado) - (Marrone, Nero, Rosso)
◇ R2, R3: 100K	(Brown, Black, Yellow) - (Bruin, zwart, Geel) - (Brun, noir, Jaune) - (Braun, Schwarz, Gelb) - (Brun, Svart, Gul) - (Ruskea, Musta, Keltainen) - (Amarillo, Morado, Marrón) - (Castanho, Preto, Amarelo) - (Marrone, Nero, Giallo)
◇ R4 ... R11: 470	(Yellow, Purple, Brown) - (Geel, Paars, Bruin) - (Jaune, Violet, Brun) - (Gelb, Violett, Braun) - (Gul, Lila, Brun) - (Keltainen, Purppura, Ruskea) - (Amarillo, Morado, Marrón) - (Amarelo, Violeta, Castanho) - (Giallo, Viola, Marrone) - (Gul, Violet, Brun)
◇ R12: 1K5	(Brown, Green, Red) - (Bruin, Groen, Rood) - (Brun, Vert, Rouge) - (Braun, Grün, Rot) - (Brun, Grön, Röd) - (Ruskea, Vihreä, Punainen) - (Marrón, Verde, Rojo) - (Castanho, Verde, Encarnado) - (Marrone, Verde, Rosso)

2 LEDs

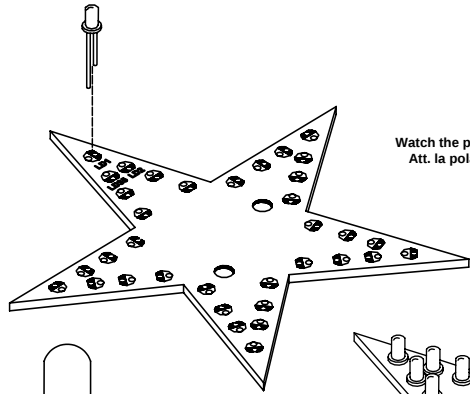
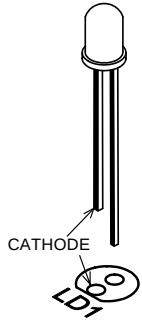

◇ LD1 ... LD35



3 Electrolytic capacitors

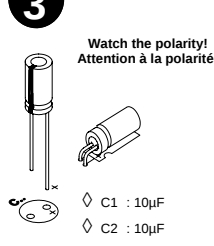

◇ C1 : 10µF
◇ C2 : 10µF

4 Transistors

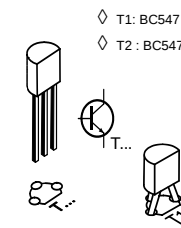

◇ T1: BC547
◇ T2 : BC547

6 Battery holder

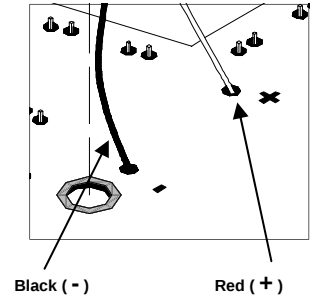
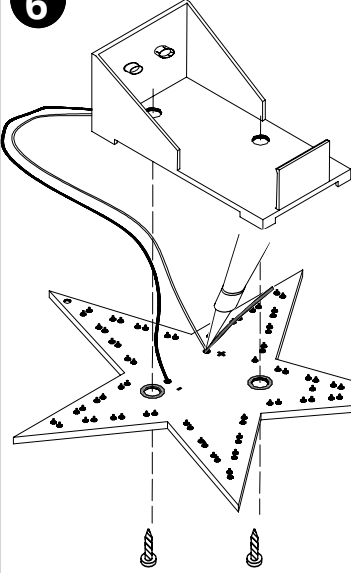

9V Batterie

5 Setup

