

**Ø 25 cm**

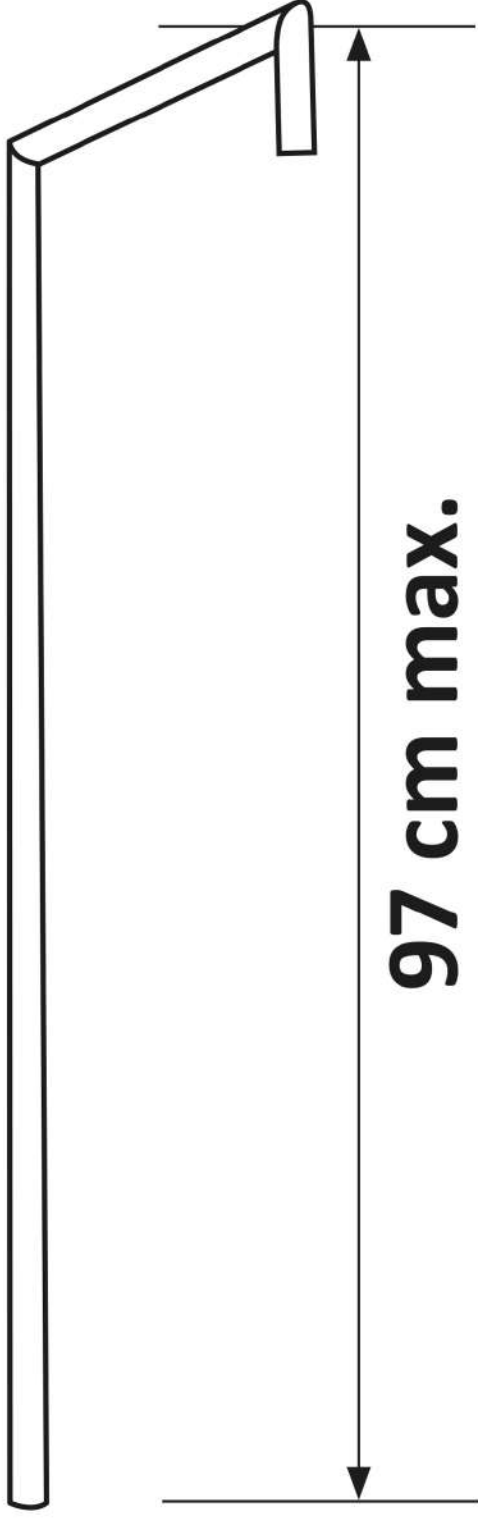

**Ø 10 cm**



**97 cm max.**

A black and white line drawing of a coiled cable. The cable is arranged in a large circle with two connectors at the bottom. The text "150cm" is written in the center of the circle.

**150cm**

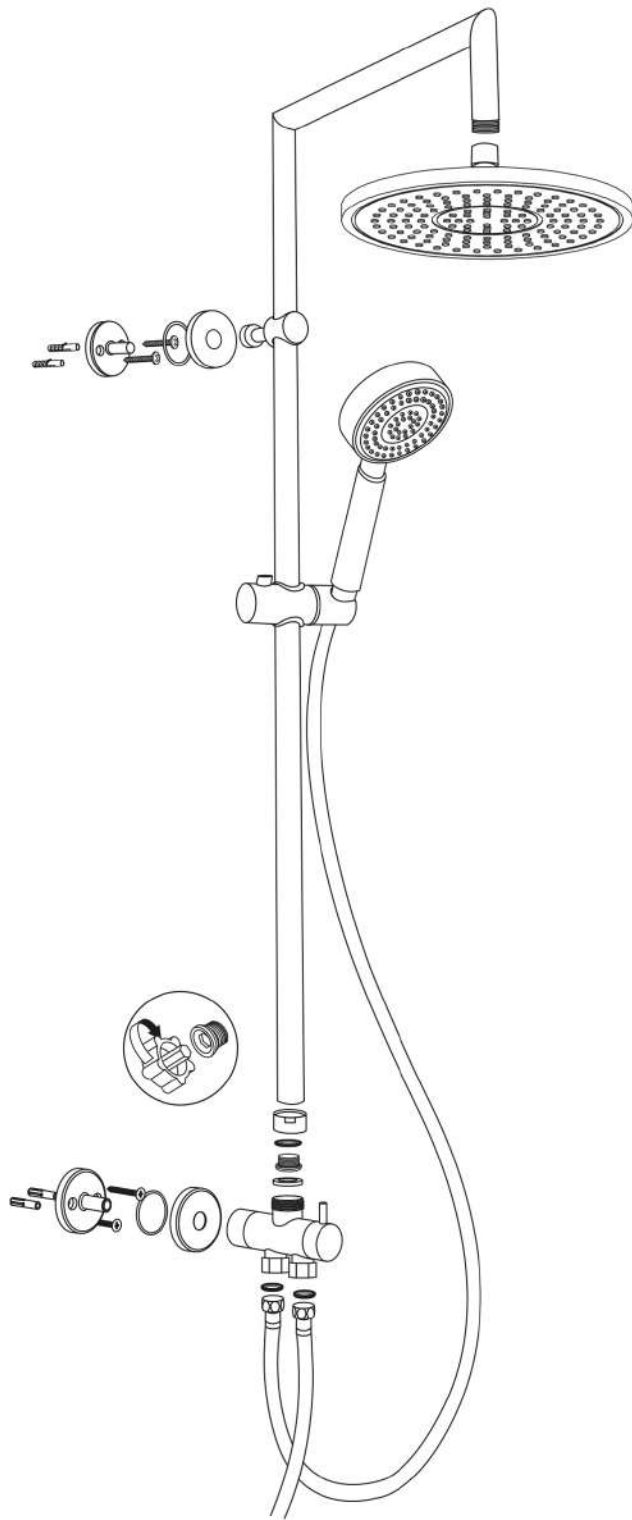

1

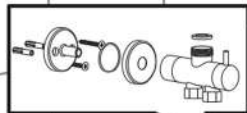
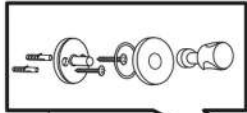

- Attach the rod holder at the desired height.
- Bevestig het stang houdertje op de gewenste hoogte.
- Fixez le porte-canne à la hauteur souhaitée.
- Befestigen Sie den Rutenhalter in der gewünschten Höhe.

2

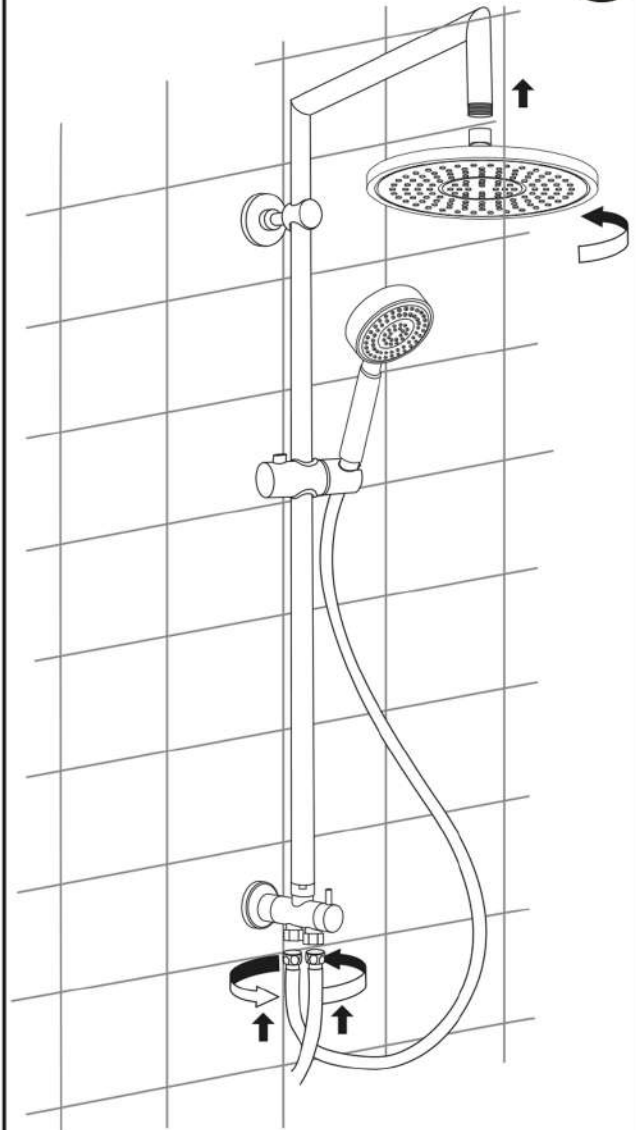

- Connect the hose of the hand shower and place the shower head on the rod.
- Sluit de slang van de handdouche aan en plaats de douchekop op de stang.
- Branchez le tuyau de la douchette à main et placez la pomme de douche sur la tige.
- Schließen Sie den Schlauch der Handbrause an und setzen Sie den Duschkopf auf die Stange.