

SCALE 1/10

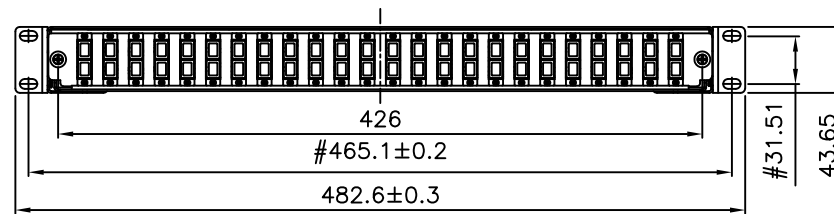
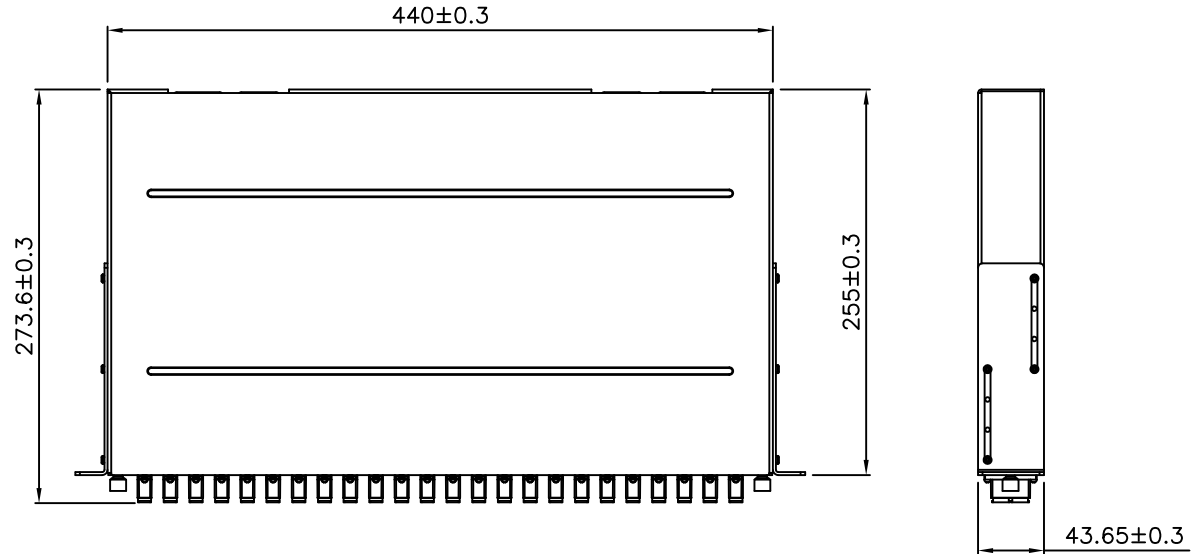
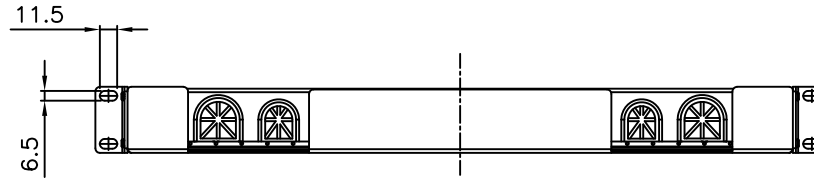
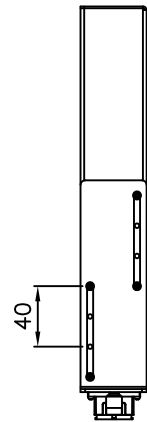

Specification :

Material :

- 1. Panel : Material : SPCC, 1.2mm Thickness, BK(RAL9005)
- 2. Adaptor
- 2-1. SC Housing : PBT, UL 94V-0, Blue color.
- 2-2. Adaptor Sleeve: Zirconia sleeve.
- 2-3. Holder : PBT, UL 94V-0, Blue color.
- 2-4. SC Dust Cover : PP, Black color.

Performance :

- a. Height : 1U(43.65mm) Width : 19"(482.6mm) Depth : 10"(255.0mm)
- b. Shelf Mounting Adjustment Range : 0~245.0mm
- c. Net Weight :
- d. SC to SC Duplex Type.
- e. Durability : 500 cycles.
- f. Tensile Strength : 10 kgf.
- g. Insertion Loss : <0.2 dB(Singlemode).
- h. Operating Temperature : -20°C to +70°C.
- i. Storage Temperature: -40°C to +80°C.

|  |  |             |                        |                  |   |
|--|--|-------------|------------------------|------------------|---|
| "#": Matching DIM.<br>"°": Important DIM.<br>Others General DIM. | DRAWING  | 26.AUG.2016 | LJM                    |                  |   |
|  | CHECK  | 26.AUG.2016 | DAY                    |                  |   |
|  | APPROVAL   | 26.AUG.2016 | JAIMY                  |                  |   |
| GENERAL TOLERANCE OF DIMENSIONS                                  | DATE   | NAME        |                        | ITEM NO.: FA2038 |   |
| X.XXX ±0.005<br>X.XX ±0.05<br>X.X ±0.1                           | SCALE  | 1/5 (A4)    | UNIT                   | mm               | DES.: Fiber panel 24 x duplex SC singlemode OS2 |
|  | DRAWING NO. Fiber panel 24 x duplex SC singlemode OS2(S01) |             | DRAWING CLASSIFICATION |                  | S SHEET 1 OF 1                                  |

